

26W / 1250lm / 4000K / On/Off / Spot 17° / 1200mm

65674



Structure

- 1 Profile
- 2 End caps
- 3 Fitting accessories
- 4 Profile coupling

Modules

A inVision Module

Design: O/M + Bartenbach GmbH

Módulo inVision em alumínio com face metálica perfurada e acabamento com pintura texturada.

LED CRI>90 / >50.000h, L80/B10 / 2-step MacAdam
Fonte de alimentação incluída.
IP20 | 230Vac | 50/60Hz



LED	4000K	Fonte de Luz	Luminária
Potência		26W	30,7W
Fluxo		2845lm	1250lm
Eficiência		113lm/W	41lm/W
LOR		-	44%
UGR		-	<10

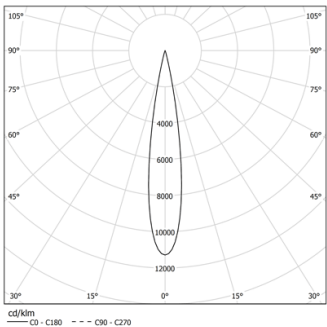

Ângulo de abertura
Spot 17°

Aplicação



Peso
0,6Kg



mm

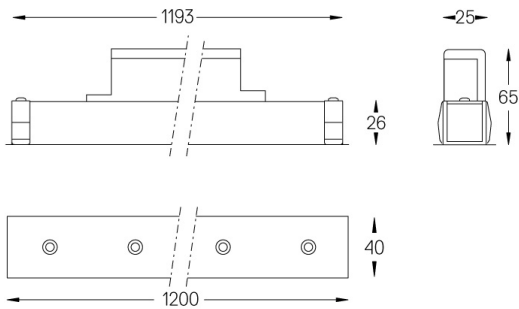

Acabamentos

Choose the length and layout of the system exactly as you want it, to model the right lighting functions for different tasks. For further information please contact: support@om-light.com