

21W / 1320lm / 2700K / On/Off / Medium 31°
/ 900mm

63334



Design: O/M + Bartenbach GmbH

Luminaire with housing of aluminium profile with electrostatic 100% polyester paint with textured-finish.

Focal-lens with complex surface and individual complex surface rips to provide a focal point through an aperture for glare free area illumination.

Special springs available on request.

LED CRI>90 / >50.000h, L80/B10 / 2-step MacAdam

Power supply included.

IP20 | 230Vac | 50/60Hz



LED	2700K	Light Source	Luminaire
Power	21W		25,6W
Flux	1800lm		1320lm
Efficiency	86lm/W		52lm/W
LOR	-		73%
UGR	-		<10

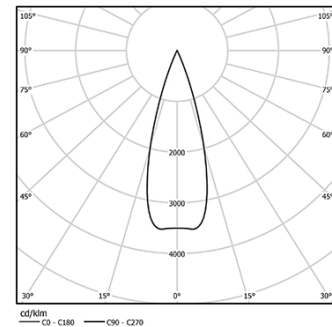

Beam angle
Medium 31°

Application



Weight
0,55Kg



26x894

Finishes

○ .01 White / RAL 9010

● .02 Black / RAL 9005

The cutout dimensions are for plasterboard ceilings. For other type of material please contact: support@om-light.com

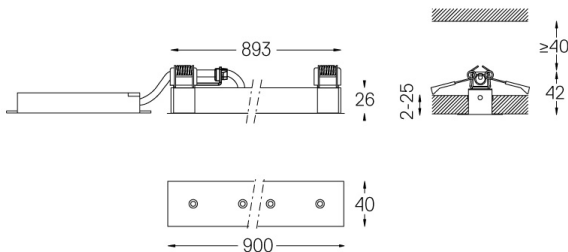

Data according to regulations

2019/2020/EU supplemented by 2021/341 | 2019/2015/EU supplemented by 2021/340/EU Energy Consumption Labelling Ordinance. This product contains light sources of efficiency class F
Model Identifier 4053560342L