

51W / 4325lm / 4000K / DALI / Wallwasher /
1200mm

65689

Design: O/M + Bartenbach GmbH
inVision module with housing and perforated cover
plate made of aluminium with textured-paint finish.

LED CRI>90 / >50.000h, L80/B10 / 2-step MacAdam
Power supply included.
IP20 | 230Vac | 50/60Hz

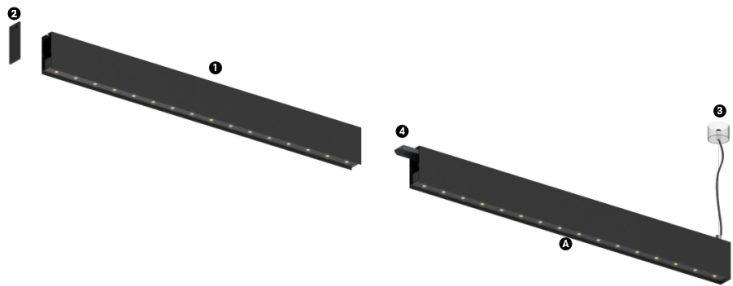

- Structure**
 - 1 Profile
 - 2 End caps
 - 3 Fitting accessories
 - 4 Profile coupling
- Modules**
 - A inVision Module

LED	4000K	Light Source	Luminaire
Power		51W	59,3W
Flux		5690lm	4325lm
Efficiency		113lm/W	73lm/W
LOR		-	76%
UGR		-	-



Beam angle
Wallwasher

Application



Weight
0,6Kg

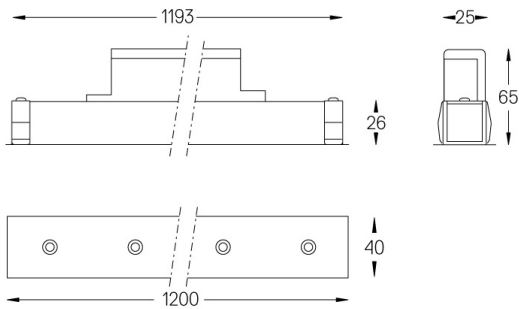

Finishes

- .01 White / RAL 9010
- .02 Black / RAL 9005

For the specific supply of "DALI 2" drivers, please contact:
support@om-light.com

Choose the length and layout of the system exactly as you want it, to
model the right lighting functions for different tasks. For further
information please contact: support@om-light.com