

26W / 1250lm / 4000K / DALI / Spot 17° / 1200mm

65686

Design: O/M + Bartenbach GmbH  
inVision module with housing and perforated cover plate made of aluminium with textured-paint finish.

LED CRI>90 / >50.000h, L80/B10 / 2-step MacAdam  
Power supply included.  
IP20 | 230Vac | 50/60Hz



- Structure**

  - 1 Profile
  - 2 End caps
  - 3 Fitting accessories
  - 4 Profile coupling
- Modules**

  - A inVision Module

LED	4000K	Light Source	Luminaire
Power		26W	30,7W
Flux		2845lm	1250lm
Efficiency		113lm/W	41lm/W
LOR		-	44%
UGR		-	<10

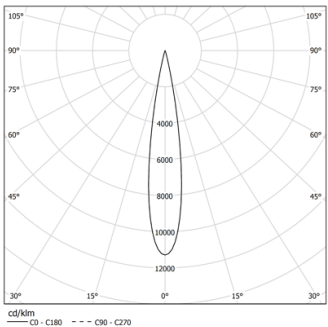

Beam angle  
Spot 17°

Application



Weight  
0,6Kg

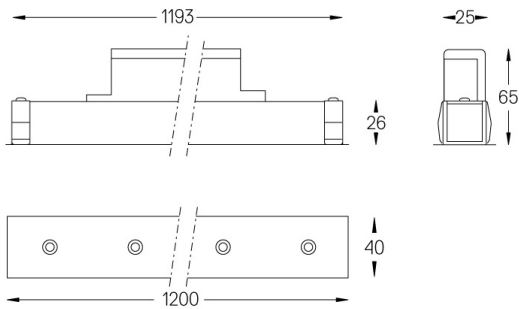

#### Finishes

For the specific supply of "DALI 2" drivers, please contact:  
support@om-light.com

Choose the length and layout of the system exactly as you want it, to model the right lighting functions for different tasks. For further information please contact: support@om-light.com