

Design: O/M + Bartenbach GmbH

Luminaire with housing of aluminium profile with electrostatic 100% polyester paint with textured-finish.

Focal-lens with complex surface and individual complex surface rips to provide a focal point through an aperture for glare free area illumination.

Special springs available on request.

LED CRI>80 / >50.000h, L80/B10 / 3-step MacAdam

Power supply included. DALI DT8

IP20 | 230Vac | 50/60Hz



LED	2200K-5000K	Light Source	Luminaire
Power		23W*	28W*
Flux		1880lm*	1420lm*
Efficiency		82lm/W	51lm/W
LOR		-	76%
UGR		-	<16



Beam angle
Flood 52°

Application



Weight
0,5Kg

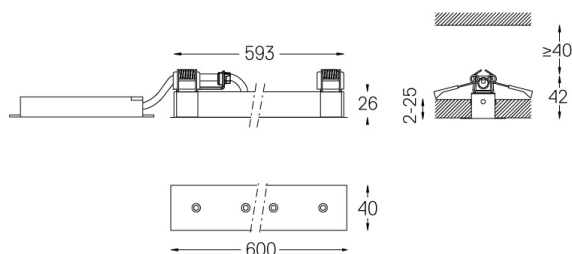

Finishes

○ .01 White / RAL 9010

● .02 Black / RAL 9005

The cutout dimensions are for plasterboard ceilings. For other type of material please contact: support@om-light.com