

52W / 4960lm / 4000K / On/Off / Medium  
31° / 1200mm

61294



#### Structure

- 1 Profile
- 2 End caps
- 3 Fitting accessories
- 4 Profile coupling

#### Modules

A inVision Module

Design: O/M + Bartenbach GmbH  
inVision module with housing and perforated cover plate made of aluminium with textured-paint finish.

LED CRI>90 / >50.000h, L80/B10 / 2-step MacAdam  
Power supply included.  
IP20 | 230Vac | 50/60Hz



| LED        | 4000K | Light Source | Luminaire |
|------------|-------|--------------|-----------|
| Power      |       | 52W          | 61,2W     |
| Flux       |       | 6800lm       | 4960lm    |
| Efficiency |       | 131lm/W      | 81lm/W    |
| LOR        |       | -            | 73%       |
| UGR        |       | -            | <10       |



Beam angle  
Medium 31°

#### Application



Weight  
0,6Kg

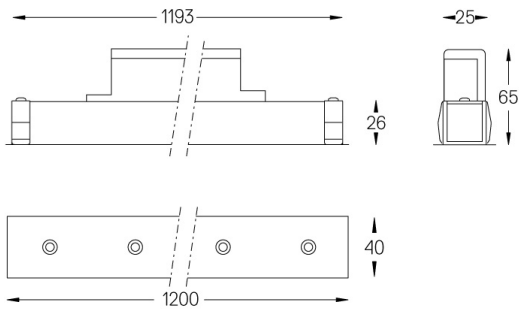

#### Finishes

- .01 White / RAL 9010
- .02 Black / RAL 9005

Choose the length and layout of the system exactly as you want it, to model the right lighting functions for different tasks. For further information please contact: [support@om-light.com](mailto:support@om-light.com)