

52W / 3920lm / 3000K / On/Off / Flood 52°
/ 1200mm

61280

Design: O/M + Bartenbach GmbH
inVision module with housing and perforated cover plate made of aluminium with textured-paint finish.

LED CRI>90 / >50.000h, L80/B10 / 2-step MacAdam
Power supply included.
IP20 | 230Vac | 50/60Hz



- Structure**
 - 1 Profile
 - 2 End caps
 - 3 Fitting accessories
 - 4 Profile coupling
- Modules**
 - A inVision Module

| LED | 3000K | Light Source | Luminaire |
|------------|-------|--------------|-----------|
| Power | | 52W | 61,2W |
| Flux | | 5160lm | 3920lm |
| Efficiency | | 99lm/W | 64lm/W |
| LOR | | - | 76% |
| UGR | | - | <16 |



Beam angle
Flood 52°

Application



Weight
0,6Kg

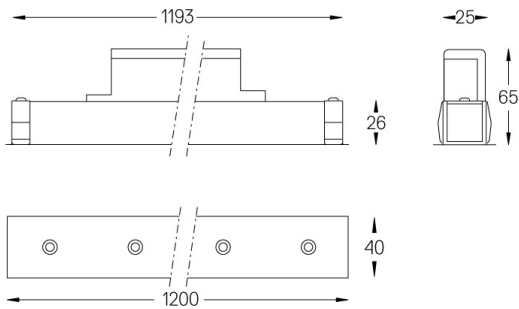

Finishes

- .01 White / RAL 9010
- .02 Black / RAL 9005

Choose the length and layout of the system exactly as you want it, to model the right lighting functions for different tasks. For further information please contact: support@om-light.com