

27W / 1760lm / 2700K / On/Off / Medium 31°  
/ 1200mm

60938

Design: O/M + Bartenbach GmbH  
inVision module with housing and perforated cover plate made of aluminium with textured-paint finish.

LED CRI>90 / >50.000h, L80/B10 / 2-step MacAdam  
Power supply included.  
IP20 | 230Vac | 50/60Hz



#### Structure

- 1 Profile
- 2 End caps
- 3 Fitting accessories
- 4 Profile coupling

#### Modules

- A inVision Module

| LED        | 2700K  | Light Source | Luminaire |
|------------|--------|--------------|-----------|
| Power      | 27W    |              | 32,9W     |
| Flux       | 2400lm |              | 1760lm    |
| Efficiency | 89lm/W |              | 53lm/W    |
| LOR        | -      |              | 73%       |
| UGR        | -      |              | <10       |



Beam angle  
Medium 31°

#### Application



Weight  
0,8Kg

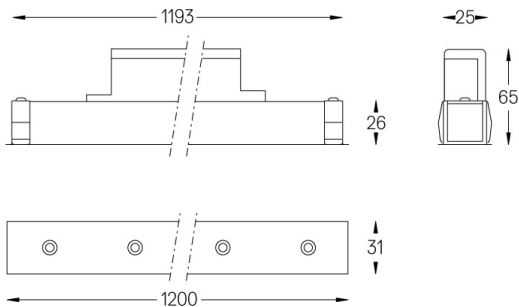

#### Finishes

- .01 White / RAL 9010
- .02 Black / RAL 9005

Choose the length and layout of the system exactly as you want it, to model the right lighting functions for different tasks. For further information please contact: [support@om-light.com](mailto:support@om-light.com)