

10W / 1110lm / 4000K / On/Off / Spot 12° /
ø45mm

60300



Design: O/M

Recessed adjustable spotlight with aluminium body.

The spotlight can be rotated up to 90° horizontally
and 330° vertically.

Easy recessing system with spring clips.

Accessories available separately and easily applicable
after installation.LED CRI>80 / >50.000h, L80/B10
2-step MacAdam / Power supply included.
IP20 | 230Vac | 50/60Hz

LED	4000K	Light Source	Luminaire
Power		10W	12,5W
Flux		1360lm	1110lm
Efficiency		136lm/W	89lm/W
LOR		-	82%
UGR		-	<13

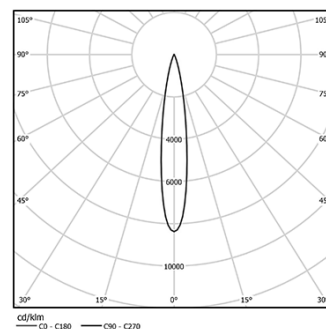
Beam angle
Spot 12°

Application

Weight
0,6Kg

194x26

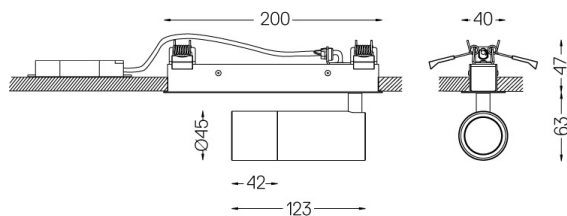

Finishes

- .01 White / RAL 9010
- .02 Black / RAL 9005

Optional

59016 Elliptical refractor

Ø39x0,5mm

59017 Soft diffuser

Ø39x0,5mm

59018 Louvre

Ø39x3mm

59019 Snoot 72mm

Ø45x72

The cutout dimensions are for plasterboard ceilings. For other type of
material please contact: support@om-light.com

Data according to regulations

2019/2020/EU supplemented by 2021/341 | 2019/2015/EU
supplemented by 2021/340/EU Energy Consumption Labelling
Ordinance. This product contains a light source of efficiency class F
Model Identifier 2053560247H