

# U

**Design: Eduardo Souto de Moura**

A true workhorse with the most complete range and largest family, U is unmatched in its flexibility and reliability. Hanging, recessed, wall-mounted, indoor and outdoor, the U range integrates effortlessly with architecture, and has the best anodized finish available: a beacon of modern design far into the future, and the quality to keep it lit.



**Double fitting system diffuser**

The double fitting system diffuser is one of the distinctive characteristics of U luminaires, which can be used flush or recessed. If the diffuser is leveled with the edges of the luminaire profile, we obtain a uniform surface without shadow lines on the ends. Or if the diffuser is recessed 5mm from the edges of the profile, this creates a thin shadow line at either end.

**Thermal dilatation system**

The diffuser presents, together with a groove at the top, a system prepared to absorb dimensional variations resulting from thermal dilatation.

# Overview



**U35**  
pag. 166



**U45**  
pag. 174



**U60**  
pag. 194



**U120**  
pag. 230

# U35

**Design:** Eduardo Souto de Moura

The U35 is a recessed, laser-thin luminaire that generates a powerful light from a single line. Integrating within architecture to the fullest extent possible, the U35's luminance, thin profile and discreet placement make it excellent for accents and graphic expression.

## **Profile**

Aluminium profile with 25 micron maximum corrosion resistance anodisation with matt finish or electrostatic 100% polyester paint with textured-finish suitable for adverse climate conditions.

## **Diffuser**

Frosted polycarbonate diffuser with user friendly clipping system and double fitting system: flushed or recessed.

## **End caps**

Aluminium anodised end caps with matt finish or electrostatic 100% polyester paint with textured-finish, suitable for adverse climate conditions.

## **Modules**

High-efficiency LED modules up to 150lm/W, with excellent colour consistency (3 step-MacAdam) and long operating lifespan (>50.000h; L70/B10).

## **Fitting accessories**

The recessing fittings accessories are needed for installing the luminaire.



# U35 Sys Planning

This system is easy to configure and can be planned in just a few steps.

1

**Layout. Design the shape and size of the luminaire.**

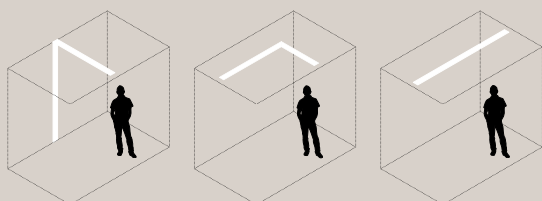

2

**Components. Check all the components you need.**

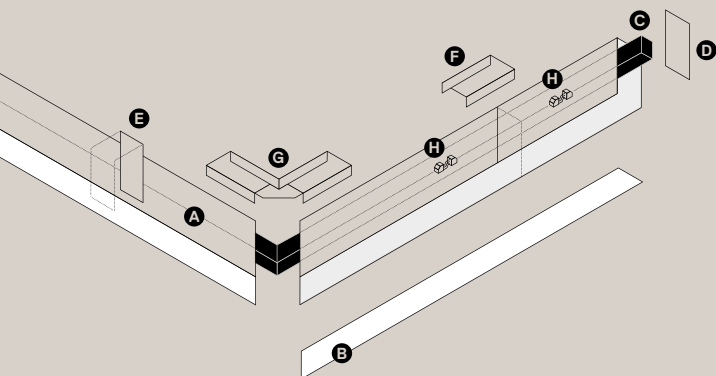

**A** Recessed aluminium profile.

**B** Frosted polycarbonate diffuser.

**C** LED light source modules available with different sizes and characteristics.

**D** End caps for each end of the line.

**E** Recessing fitting accessories for installation of the luminaire.

**F** Concealed connections between profiles.

**G** Concealed corner connections between profiles.

**H** Safe and easy electrical connections between LED modules.

3

**Light Source Modules.**



LED

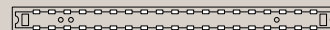

High-efficiency LED modules up to 150lm/W, excellent linearity and uniformity of light.

4

**Measure, calculate and design the luminaire.**

Use the formula indicated below to determine which modules best match your requirements. You will find all the lengths available on the modules page.

Recessed



LED

M + 30mm

**M** Sum of the lengths of the light source modules.

5

**Choose the finish. To select the required finish, add the finish code to the end of the profile and end caps code.**

Profile

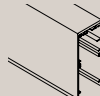

50001

+

Finish

.10

=

Final code

50001.10

# U35 Sys Ordering

Select the codes of the various components.

## Recessed

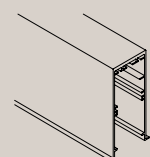

### Profile

Unit=1m

**50001**

Aluminium

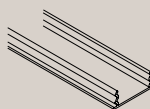

### Diffuser

Unit=1m

**50002**

Frosted

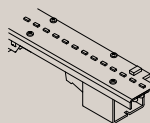

### Module

LED

pag. 172

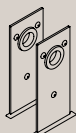

### End cap

Set of two

**50003**

Aluminium



### Fitting

### accessories

**50047**

A fitting accessory must be applied at the end of each profile section and every 1,16m.



## Connectors

Module connector

**54038** On/Off

**54083** DALI

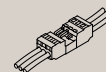

Profile coupling

**50004**

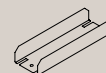

Corner coupling

**50005** for 90°

**50006** Custom angle

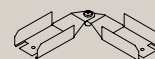

Wall-ceiling coupling

**50060** for 90°



## Finishes

Max. length 3m:

● .01 White

● .02 Black

● .00 RAL on request

Max. length 6m:

● .10 Anodised aluminium

# U35 Sys



This system is a versatile solution for creating a customised luminaire. The flexibility of this product is reflected in the possibility of choosing different layouts. The extremely reduced thickness of U35 is the characteristic that differentiates this product. The system components must be selected according to the geometry required.

LED CRI>80 / >50.000h, L70/B10 / 3-step MacAdam  
Power supply included.



IP42 | 230Vac | 50/60Hz



## U35 Sys Recessed

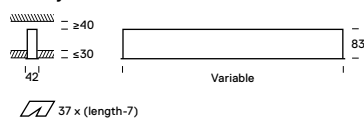

	Light Source Power	Light Source Flux	Luminaire Flux	On/Off Code	DALI Code
--	--------------------	-------------------	----------------	-------------	-----------

### U35 Sys Modules



#### 3000K

838mm	13W	1850lm	950lm	50050	50023
1117mm	17W	2450lm	1250lm	50052	50025
1396mm	21W	3100lm	1600lm	50054	50027
1675mm	25W	3700lm	1950lm	50013	50029
1955mm	29W	4300lm	2250lm	50015	50035
2234mm	33W	4900lm	2600lm	50017	50037
2513mm	37W	5550lm	2900lm	50019	50039
2792mm	41W	6150lm	3200lm	50021	50041
3071mm	45W	6800lm	3550lm	50056	50043
3350mm	49W	7400lm	3850lm	50058	50045

#### 4000K

838mm	13W	1950lm	1000lm	50051	50024
1117mm	17W	2600lm	1350lm	50053	50026
1396mm	21W	3250lm	1700lm	50055	50028
1675mm	25W	3900lm	2050lm	50014	50030
1955mm	29W	4550lm	2350lm	50016	50036
2234mm	33W	5200lm	2700lm	50018	50038
2513mm	37W	5850lm	3050lm	50020	50040
2792mm	41W	6500lm	3400lm	50022	50042
3071mm	45W	7150lm	3700lm	50057	50044
3350mm	49W	7800lm	4050lm	50059	50046