

inVision





inVision Sys Planning

This system is easy to configure and can be planned in just a few steps.

1

Components. Check all the components you need.

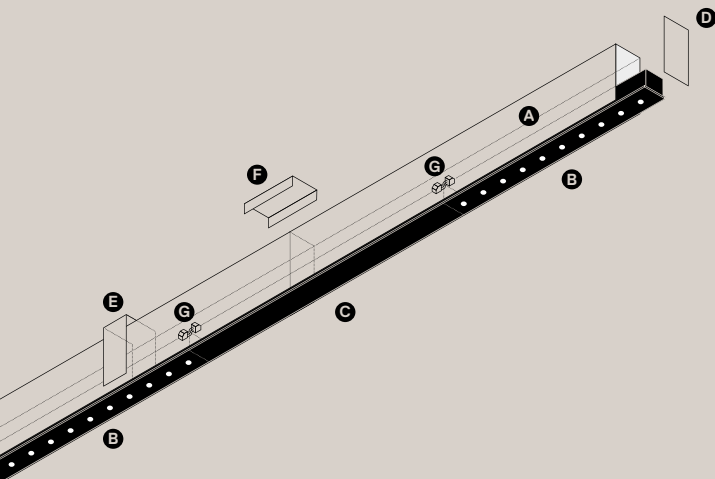

A Recessed aluminium profile.

B LED light source modules available with different sizes and characteristics.

C Blind modules available in two sizes (**opcional**).

D End caps for each end of the line.

E Recessing fitting accessories for installation of the luminaire.

F Concealed connections between profiles.

G Safe and easy electrical connections between LED modules.

2

Light Source Modules.



High-efficiency O/M LED modules up to 115lm/W.

3

Measure, calculate and design the luminaire.

Use the formula indicated below to determine which modules best match your requirements. You will find all the lengths available on the modules page.

Recessed



LED

M + 11mm

M Sum of the lengths of the light source modules.

4

Choose the finish. To select the required finish, add the finish code to the end of the profile and end caps code.

Profile		Finish		Final code
50001	+	.01	=	50001.10

inVision Sys Ordering

Select the codes of the various components.

Recessed

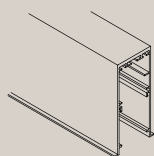
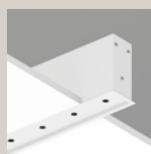

Profile

Unit=1m

50001

Aluminium

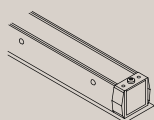

Module

LED
Blind

pag. 78

Aluminium

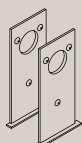

End cap

Set of two

50003

Aluminium



Fitting accessories

50047

A fitting accessory must be applied at the end of each profile section and every 1,16m.



Connectors

Module connector

45001 On/Off

45002 DALI

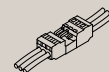

Blind modules connector

300mm modules

45003 On/Off

45004 DALI

600mm modules

45007 On/Off

45008 DALI

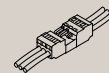

Profile coupling

50004

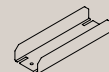

Finishes

Max. length 3m:

● .01 White

● .02 Black

inVision Sys



Glare free luminaire with extremely reduced thickness that allows to integrate modules that don't emit light (blind modules).

This system is a versatile solution for creating a customised luminaire.

The flexibility of this product is reflected in the possibility of choosing different layouts.

The system components must be selected according to the geometry required.

LED CRI>80, 2700K>90 / >50.000h, L80/B10 / 3-step MacAdam
Power supply included.



IP20 | 230Vac | 50/60Hz



inVision Sys Recessed

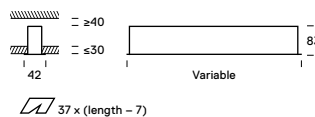

Medium 30°



Wide flood 50°



	Light Source Power	Light Source Flux	Luminaire Flux	On/Off Code	DALI Code
inVision Sys Modules					
					
LED					
2700K					
Medium					
600mm	12W	1100lm	700lm	45010	45016
1200mm	24W	2200lm	1400lm	45012	45018
Wide flood					
600mm	12W	1100lm	770lm	45011	45017
1200mm	24W	2200lm	1550lm	45013	45019
3000K					
Medium					
600mm	12W	1500lm	850lm	45022	45028
1200mm	24W	3000lm	1700lm	45024	45030
Wide flood					
600mm	12W	1500lm	920lm	45023	45029
1200mm	24W	3000lm	1850lm	45025	45031
4000K					
Medium					
600mm	12W	1600lm	1000lm	45034	45040
1200mm	24W	3250lm	2000lm	45036	45042
Wide flood					
600mm	12W	1600lm	1100lm	45035	45041
1200mm	24W	3250lm	2200lm	45037	45043
Tunable White 2700K - 4000K					
Medium					
600mm	25,5W*	2300lm*	1600lm*	-	45046
1200mm	51W*	4600lm*	3200lm*	-	45048
Wide flood					
600mm	25,5W*	2300lm*	1770lm*	-	45047
1200mm	51W*	4600lm*	3550lm*	-	45049

*Values at full intensity

Code

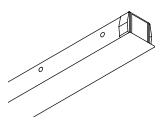

Blind modules

300mm	45005
600mm	45006

Finishes ○ .01 White ● .02 Black